



# D-Connector and D-Connector Hood Accessories



A complete range of D-Connector locking and mounting accessories, such as mounting brackets, screw locks, thread locks, spring brackets, slide locks, strain reliefs, snap rivets, metal clamps, cable bushings, flat washers, spring washers, M3/UNC 4-40 screws and nuts.

## ■ Slide lock assembly (universal)

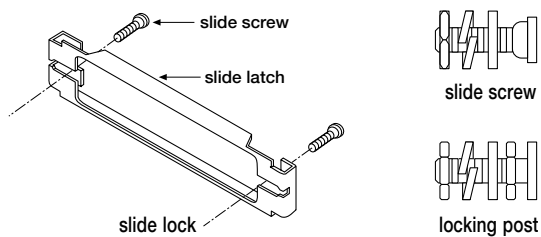

Only to be used with hoods without locking screws.

### ORDERING INFORMATION

<b>DKB-XXSL-0000</b>	with self-tapping screws (standard)
<b>DKB-XXSL-0100</b>	with UNC 4-40 screws, washers and nuts
<b>DKB-XXSL-0200</b>	with M3 screws, washers and nuts
	available circuit sizes: 09, 15, 25, 37, 50
<b>DKB-00LP-0000</b>	locking post for slide lock assembly

## ■ Spring/Screw lock assembly

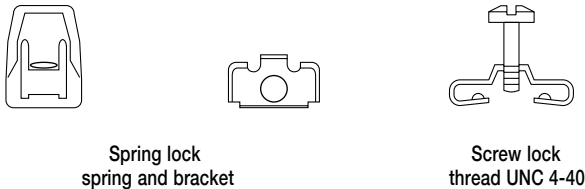

Only to be used with hoods without locking screws.

### ORDERING INFORMATION

<b>DKB-00SL-5000</b>	spring lock 09 to 37 way
<b>DKB-00SL-8000</b>	screw lock 09 to 37 way

## ■ Hand locking screws

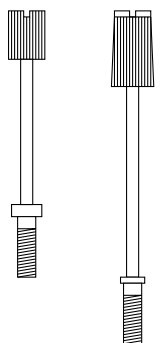

model  
8000

model  
7000

### ORDERING INFORMATION

<b>DKB-00LS-8000</b>	8000 series, (steel)
<b>DKB-00LS-7000</b>	7000 series (steel and plastic) black
<b>DKB-00LS-7008</b>	7000 series (steel and plastic) grey



# D-Connector and D-Connector Hood Accessories

## ■ Thread lock assembly, brass nickel plated

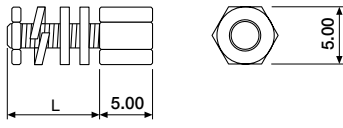

Model 418X/518X

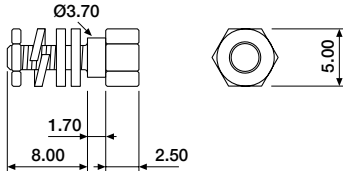

Model 6180/7180

Thread lock assemblies, if ordered with nuts and washers, consist of 1 nut, 2 washers and 1 lock washer.  
Some combinations of length, O.D. and I.D. are subject to M.O.Q.

### ORDERING INFORMATION

DKB-XXTL-418X with nut and washers  
 DKB-XXTL-518X without nut and washers

0 = O.D. UNC 4-40, I.D. UNC 4-40  
 1 = O.D. M3, I.D. UNC 4-40  
 2 = O.D. UNC 4-40, I.D. M3  
 3 = O.D. M3, I.D. M3

available lengths: (L)  
 05, 06, 08, 11, 13, 17mm

DKB-08TL-6180 with nut and washers  
 DKB-08TL-7180 without nut and washers

## ■ Thread lock assembly, steel tin plated

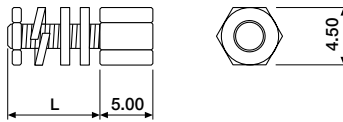

Model 818X/918X

Thread lock assemblies, if ordered with nuts and washers, consist of 1 nut, 2 washers and 1 lock washer.  
Some combinations of length, O.D. and I.D. are subject to M.O.Q.

### ORDERING INFORMATION

DKB-XXTL-818X with nut and washers  
 DKB-XXTL-918X without nut and washer

0 = O.D. UNC 4-40, I.D. UNC 4-40  
 1 = O.D. M3, I.D. UNC 4-40  
 2 = O.D. UNC 4-40, I.D. M3  
 3 = O.D. M3, I.D. M3

available lengths: (L)  
 05, 06, 08, 11, 13, 17mm

## ■ Distance nut, brass nickel plated

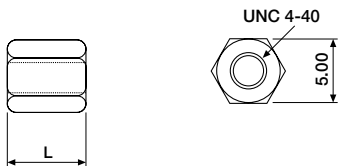

### ORDERING INFORMATION

DKB-XXDN-0000 distance nut with UNC 4-40 thread

available lengths: (L)  
 05, 06, 07, 08, 10, 12mm

## ■ Mounting brackets

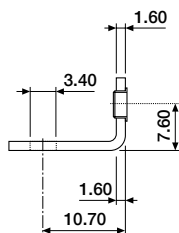

Metal  
09 to 37 circuits

### ORDERING INFORMATION

DKB-00MB-1050 metal, with M3 thread  
 DKB-00MB-1060 metal, with UNC 4-40 thread



# D-Connector and D-Connector Hood Accessories

## ■ Strain relief/cut out cover for full metal hoods series 9000 to 9200

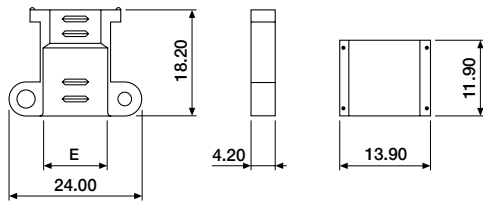

strain relief

cut out cover

Each strain relief consists of 2 shells and 2 self tapping screws.

### ORDERING INFORMATION

<b>DKB-00CC-9050</b>	cut out cover 09 to 37 circuits
<b>DKB-00CC-9150</b>	cut out cover 50 circuits (not drawn)
<b>DKB-90SR-XXXX</b>	strain relief 09 to 37 circuits
<b>DKB-92SR-XXXX</b>	strain relief 50 circuits (not drawn)

### DIMENSIONS

E = 4.00mm to 14.00mm for 09 to 37 circuits  
E = 8.00mm to 16.00mm for 50 circuits

## ■ Crimp type strain relief for full metal hoods, series 9000 to 9400

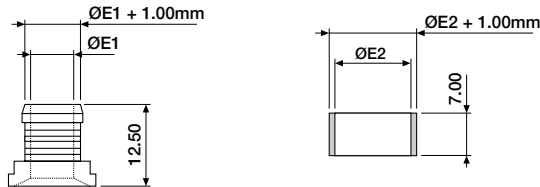

outer ferrule

### ORDERING INFORMATION

<b>DKB-10IF-XXXX</b>	inner ferrule, 09 to 37 circuits
<b>DKB-20IF-XXXX</b>	inner ferrule, 50 circuits (not drawn)
<b>DKB-00OF-XXXX</b>	outer ferrule

inside diameter, inner ferrule:  
0030 (for ØE1 = 3.00mm) min ØE1  
0090 (for ØE1 = 9.00mm) max ØE1

inside diameter, outer ferrule:  
0060 (for ØE2 = 6.00mm) min ØE2  
0140 (for ØE2 = 14.00mm) max ØE2

Available in increments of 0.50mm. For each increment of 0.50mm the last digit of the order number is increased by 5.  
Contact sales office for availability.

## ■ Metal clamps

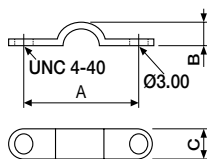

Material thickness = 0.80mm to 0.90mm  
2 clamps together with 2 UNC 4-40 screws  
can be used as cable strain relief.

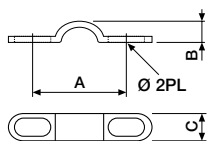

Material thickness = 1.00mm to 1.20mm  
Used in D-connector hoods series 3000, 4000, 7000, 8000

### ORDERING INFORMATION

<b>DKB-00MC-2000</b>	A = 10.70, B = 2.85, C = 5.90
<b>DKB-00MC-2100</b>	A = 13.20, B = 2.90, C = 5.90
<b>DKB-00MC-2200</b>	A = 20.10, B = 3.90, C = 6.90
<b>DKB-00MC-4000</b>	A = 11.50, B = 2.50, C = 4.70, Ø = 2.70
<b>DKB-00MC-4100</b>	A = 15.60, B = 2.50, C = 4.70, Ø = 2.70
<b>DKB-00MC-7000</b>	A = 14.90, B = 2.50, C = 5.70, Ø = 3.20
<b>DKB-00MC-7100</b>	A = 21.90, B = 3.30, C = 6.20, Ø = 3.20
<b>DKB-00MC-8000</b>	A = 11.00, B = 2.10, C = 6.30, Ø = 3.50
<b>DKB-00MC-8100</b>	A = 16.00, B = 3.20, C = 6.30, Ø = 3.20 x 3.90



# D-Connector and D-Connector Hood Accessories

## ■ Dust covers

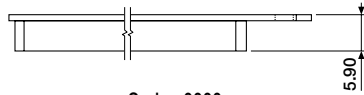

Series 0000  
09 to 37 circuits

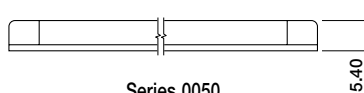
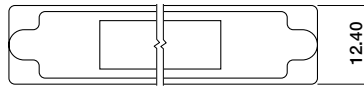

Series 0050  
09 to 37 circuits

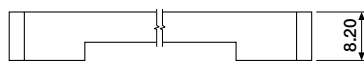
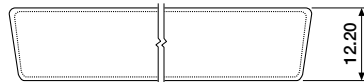

Series 1000  
09 to 50 circuits

### ORDERING INFORMATION

<b>DKM-XXC0-0000</b>	male, black series 0000
<b>DK F-XXC0-0000</b>	female, black series 0000
<b>DKM-XXC0-0050</b>	male, blue RF series 0050, metalised
<b>DK F-XXC0-0050</b>	female, red RF series 0050, metalised
<b>DKM-XXC0-1000</b>	male, transparent series 1000
<b>DK F-XXC0-1000</b>	female, transparent series 1000

available circuit sizes:  
09, 15, 25

Contact sales office for D-connector O-rings and seals.

## ■ Cable bushings

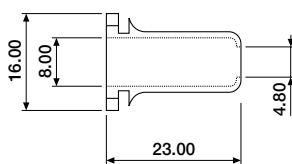

Series 7000

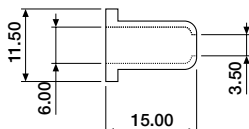

Series 8000

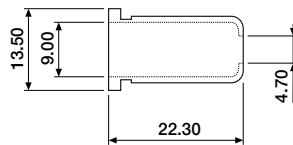

Series 8010

### ORDERING INFORMATION

<b>DKB-00CB-7000</b>	for 7000 series hoods, 15 to 37 circuits
<b>DKB-00CB-8000</b>	for 8000 series hoods, 09 & 15 circuits
<b>DKB-00CB-8010</b>	for 8000 series hoods, 25 & 37 circuits



# D-Connector and D-Connector Hood Accessories

## ■ Screws, nuts and washers

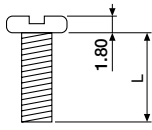

screw with  
UNC 4-40 thread



nut for UNC 4-40  
or M3 thread



flat washer



lock washer

### ORDERING INFORMATION

<b>DKB-00FW-0000</b>	flat washer for M3 and UNC 4-40 screws
<b>DKB-00LW-0000</b>	lock washer for M3 and UNC 4-40 screws
<b>DKB-00HN-0000</b>	nut for UNC 4-40 thread
<b>DKB-00HN-1000</b>	nut for M3 thread
<b>DKB-00BS-0000</b>	mounting screw with UNC 4-40 thread, L = 6.80