

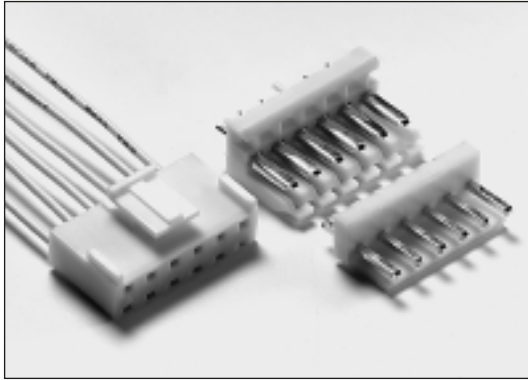

3.96mm Crimp Type Housings and Headers

Positive Locked



A series of 1.14mm square pin headers, straight and right-angle together with a positive lockable crimp type housing. Wires have to be crimped to a boxed type contact to make complete assembly.

Material : 6/6 Nylon, UL 94V-2
Contacts : Copper Alloy
Plating : Tin over Nickel
Electrical : See Chapter 15

■ Header, straight

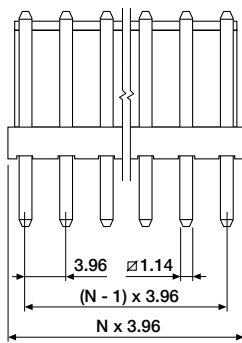

PCB Hole Size = $\varnothing 1.70/1.80$ mm

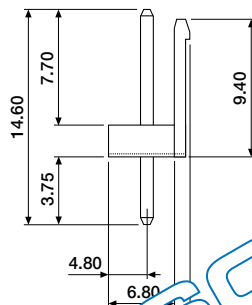

ORDERING INFORMATION

FLH-XXDS-0009

tin plated

available circuit sizes:
02 to 12

■ Header, right-angle

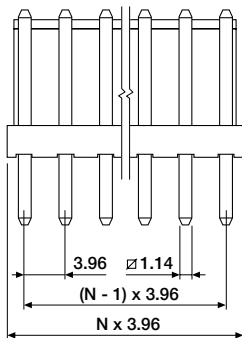

PCB Hole Size = $\varnothing 1.70/1.80$ mm

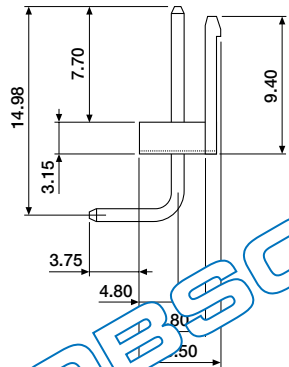

ORDERING INFORMATION

FLH-XXDS-1009

tin plated

available circuit sizes:
02 to 12



3.96mm Crimp Type Housings and Headers

Positive Locked

■ Crimp type housing

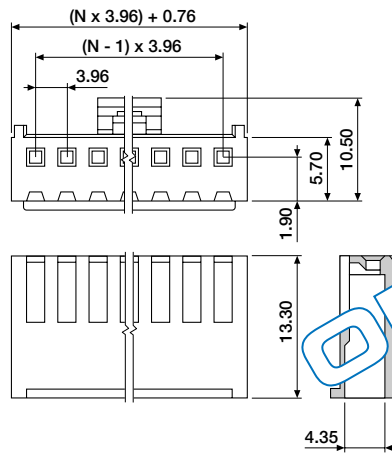

ORDERING INFORMATION

KLS-XXXK-0009 tin plated
available circuit sizes:
02 to 12

■ Crimp type terminals, loose

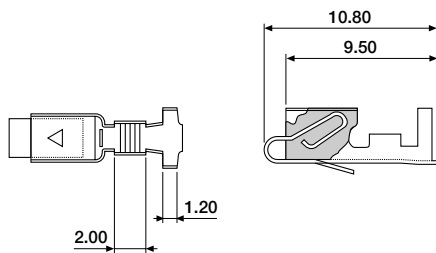

ORDERING INFORMATION

KLS-XXXK-0009* tin plated, AWG 22-26
FL-00KT-1009* tin plated, AWG 18-22
HGS-00KT-1200 hand crimp tool, AWG 18-28

*For use with model KLS-XXXK-0009 only.