



2.54mm and 5.08mm Breakable Header Strips

Symmetric Body, 1 and 2 Rows



A complete range of straight, right-angle, single and double row headers with 2.54mm or 5.08mm spacing, through board and surface mount. All straight models are available as double decker (two bodies).

Material : Glass-filled Polyamide, UL 94V-0
 Contacts : Phosphor Bronze
 Plating : Tin or Gold over Nickel
 Tolerances : $\pm 0.25\text{mm}$ (A, B and C dimensions)
 $\pm 0.15\text{mm}$ (other dimensions)
 Electrical : See Chapter 15

Single row, straight

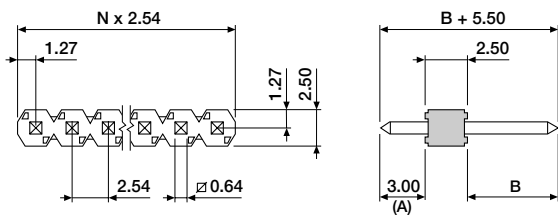

Any combination of the A and B dimensions is possible.
 (M.O.Q. = 100 pcs 40 way strips).
 For headers with 5.08mm spacing change order No. to 82812XX-XX-XX (18 circuits max).
 *Gold plated models with a total pin length above 29.50mm are subject to M.O.Q.

ORDERING INFORMATION & DIMENSIONS

82802XX-XX-01 tin plated
 82802XX-XX-02 gold plated
 available circuit sizes:
 01 to 40
 for pin No. see chart below

Pin No.	B	Pin No.	B	Pin No.	B	Pin No.	B
18	4.50	08	10.00	10	18.00		
00	6.00	05	11.90	12	20.50		
01	7.00	09	13.10	11	21.50		
02	8.10	06	13.60	13	23.00		
03	8.60	07	14.10	21	24.00		
04	9.10	24	15.50				

Single row, straight, surface mount

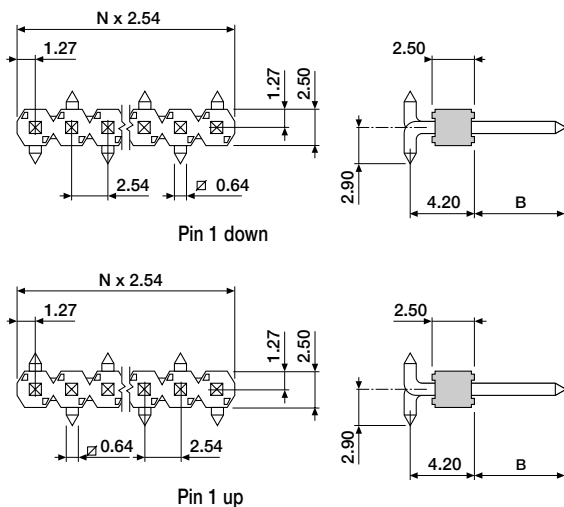

PCB Pad Size = 1.00mm x 3.00mm.

ORDERING INFORMATION & DIMENSIONS

83802XX-XX-61 tin plated (Pin 1 up)
 83802XX-XX-62 gold plated (Pin 1 up)
 83802XX-XX-91 tin plated (Pin 1 down)
 83802XX-XX-92 gold plated (Pin 1 down)
 available circuit sizes:
 02 to 40
 for pin No. see chart below

Pin No.	B	Pin No.	B	Pin No.	B	Pin No.	B
00	5.20	03	7.80	06	11.10	09	13.30
01	6.20	04	8.30	07	12.30		
02	7.30	05	9.30	08	12.80		



2.54mm and 5.08mm Breakable Header Strips

Symmetric Body, 1 and 2 Rows

Single row, dual body, straight

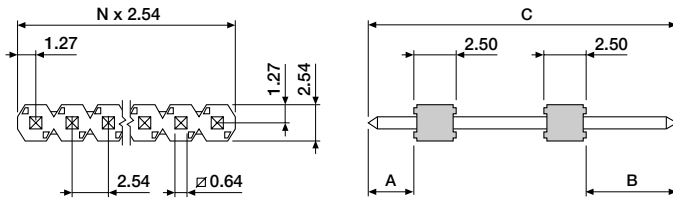

Any combination of the A and B dimensions is possible.
 (M.O.Q. = 100 pcs 40 way strips).
 For headers with 5.08mm spacing change order No. to 84812XX-XX-XX
 (20 circuits max).
 *Gold plated models with a total pin length above 29.50mm are subject to M.O.Q.

ORDERING INFORMATION & DIMENSIONS

84802XX-XX-01-XX/XXX tin plated
 84802XX-XX-02-XX/XXX gold plated

B dimension in 0.10mm increments
 A dimension in 0.10mm increments

available circuit sizes:
 01 to 40

for pin No. see chart below

Pin No.	C	Pin No.	C	Pin No.	C	Pin No.	C
00	11.50	08	15.60	24	21.00	21	29.50
01	12.50	05	17.40	10	23.50	14*	31.00
02	13.60	09	18.60	12	26.00	15*	33.50
03	14.10	06	19.10	11	27.00	16*	35.00
04	14.60	07	19.60	13	28.50	17*	37.50

Double row, straight

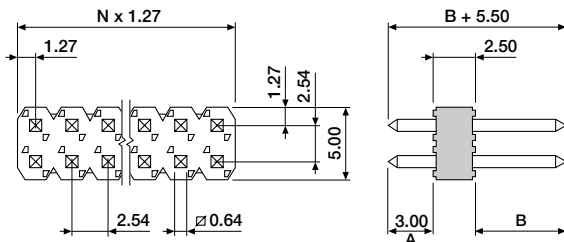

Any combination of the A and B dimensions is possible.
 (M.O.Q. = 100 pcs 80 way strips).
 For headers with 5.08mm spacing change order No. to 82814XX-XX-XX
 (40 circuits max).
 *Gold plated models with a total pin length above 29.50mm are subject to M.O.Q.

ORDERING INFORMATION & DIMENSIONS

82804XX-XX-01 tin plated
 82804XX-XX-02 gold plated

available circuit sizes:
 04 to 80

for pin No. see chart below

Pin No.	B	Pin No.	B	Pin No.	B	Pin No.	B
18*	4.50	08	10.00	10	18.00		
00	6.00	05	11.90	12	20.50		
01	7.00	09	13.10	11	21.50		
02	8.10	06	13.60	13	23.00		
03	8.60	07	14.10	21	24.00		
04	9.10	24	15.50				

Double row, straight, surface mount

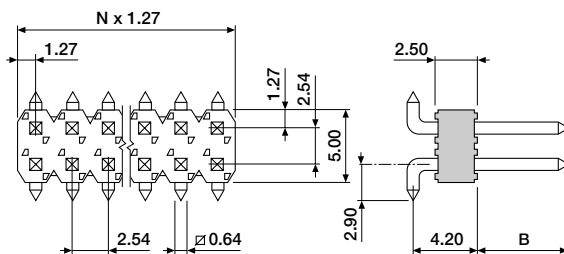

PCB Pad Size = 1.00mm x 4.50mm.
 For headers with 5.08mm spacing change order No. to 83814 XX-XX-XX
 (40 circuits max).

ORDERING INFORMATION & DIMENSIONS

83804XX-XX-01 tin plated
 83804XX-XX-02 gold plated

available circuit sizes:
 04 to 80

for pin No. see chart below

Pin No.	B	Pin No.	B	Pin No.	B	Pin No.	B
00	5.20	03	7.80	06	11.10	09	13.30
01	6.20	04	8.30	07	12.30		
02	7.30	05	9.30	08	12.80		



2.54mm and 5.08mm Breakable Header Strips

Symmetric Body, 1 and 2 Rows

Double row, dual body, straight

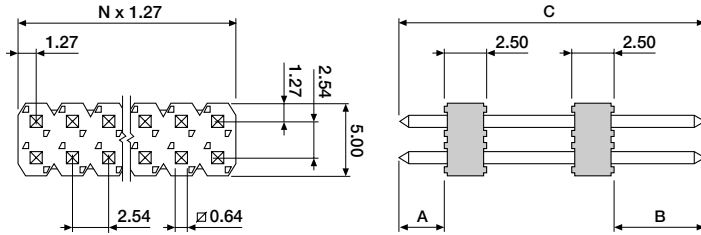

Any combination of the A and B dimensions is possible.
 (M.O.Q. = 100 pcs 80 way strips).
 For headers with 5.08mm spacing change order No. to 84814XX-XX-XX
 (40 circuits max).
 *Gold plated models with a total pin length above 29.50mm are subject to M.O.Q.

ORDERING INFORMATION & DIMENSIONS

84804XX-XX-01-XX/XXX tin plated
 84804XX-XX-02-XX/XXX gold plated

B dimension in 0.10 mm increments
 A dimension in 0.10mm increments

available circuit sizes:
 04 to 80

for pin No. see chart below

Pin No.	C	Pin No.	C	Pin No.	C	Pin No.	C
00	11.50	08	15.60	24	21.00	21	29.50
01	12.50	05	17.40	10	23.50		
02	13.60	09	18.60	12	26.00		
03	14.10	06	19.10	11	27.00		
04	14.60	07	19.60	13	28.50		

Single row, right-angle

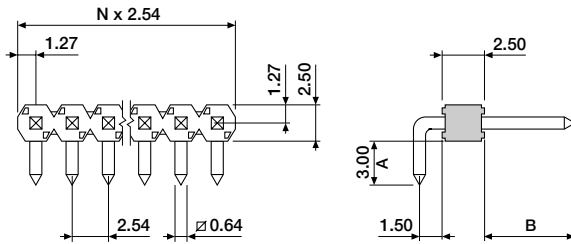

Contact sales office for other combinations of A and B dimensions.
 (M.O.Q. = 100 pcs 40 way strips).
 For headers with 5.08mm spacing change order No. to 84813XX-XX-XX
 (20 circuits max).

ORDERING INFORMATION & DIMENSIONS

82803XX-XX-01 tin plated
 82803XX-XX-02 gold plated

available circuit sizes:
 01 to 40

for pin No. see chart below

Pin No.	B	Pin No.	B	Pin No.	B	Pin No.	B
20	3.60	02	6.80	05	10.80	08	15.70
00	5.80	03	7.80	06	11.30		
01	6.30	04	9.60	07	11.80		

Single row, right-angle

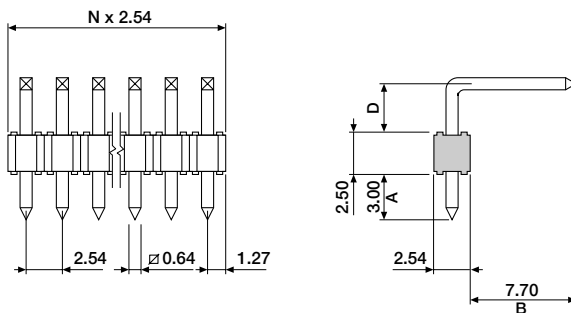

Contact sales office for other combinations of A and B dimensions.
 For headers with 5.08mm spacing change order No. to 8281380-XX-XX/8281390-XX-XX
 (20 circuits max).

ORDERING INFORMATION

8280380-XX-01 tin plated B = 7.70 D = 3.28
 8280380-XX-02 gold plated B = 7.70 D = 3.28
 8280390-XX-01 tin plated B = 6.80 D = 6.30
 8280390-XX-02 gold plated B = 6.80 D = 6.30

available circuit sizes:
 01 to 40



2.54mm and 5.08mm Breakable Header Strips

Symmetric Body, 1 and 2 Rows

Single row, right angle, surface mount

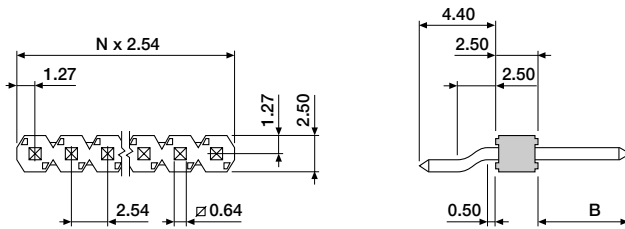

PCB Pad Size = 1.00mm x 3.50mm
 For headers with 5.08mm spacing change order No. to 83813XX-XX-XX
 (20 circuits max).

ORDERING INFORMATION & DIMENSIONS

83803XX-XX-01 tin plated
 83803XX-XX-02 gold plated

available circuit sizes:
 01 to 40

for pin No. see chart below

Pin No.	B	Pin No.	B	Pin No.	B	Pin No.	B
00	4.60	03	7.20	06	10.50	09	12.70
01	5.60	04	7.70	07	11.70		
02	6.70	05	8.70	08	12.20		

Double row, right-angle

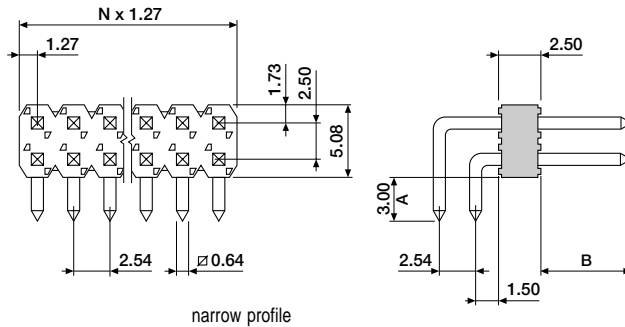

ORDERING INFORMATION

82805XX-XX-01 narrow profile, tin plated
 82805XX-XX-02 narrow profile, gold plated
 82807XX-XX-01 wide profile, tin plated
 82807XX-XX-02 wide profile, gold plated

available circuit sizes:
 04 to 80

for pin No. see chart below

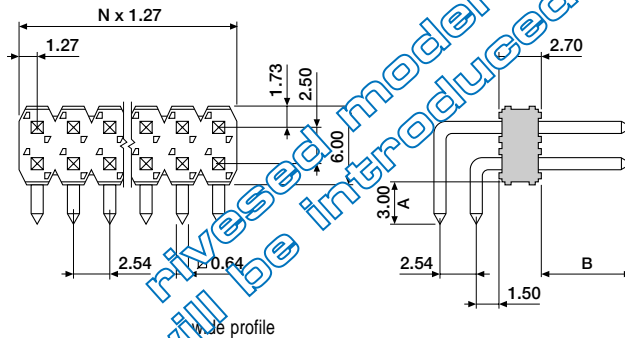

DIMENSIONS

narrow profile

wide profile

Pin No.	B
03	4.70
04	5.80
00	6.30
01	6.80
02	10.80
05	13.20

Pin No.	B
03	4.20
04	5.30
00	5.80
01	6.30
02	10.30
05	12.70

Contact sales office for other combinations of A and B dimensions.
 For headers with 5.08mm spacing change order No. to 82815XX-XX-XX/82817-XX-XX-XX
 (40 circuits max).