

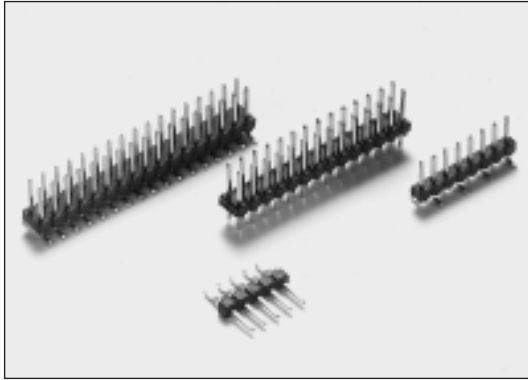

2.54mm Breakable Header Strips

Selective Gold Plated, 1 and 2 Rows



This complete range of straight, right-angle, single and double row headers also includes single and double row models for surface-mount. All headers are supplied in breakable strips of 1 x 40 and 2 x 40 pins. A high temperature body of PPS is available for all models against M.O.Q.

- Material : Glass-filled Polyester, UL 94V-0
40% Glass-filled PPS, UL 94 V-0 (M.O.Q.)
- Contacts : Brass
- Plating : Selective Gold over Nickel
- Tolerances : $\pm 0.25\text{mm}$ (A, B and C dimensions)
 $\pm 0.10\text{mm}$ (other dimensions)
- Electrical : See Chapter 15

■ Single row, straight

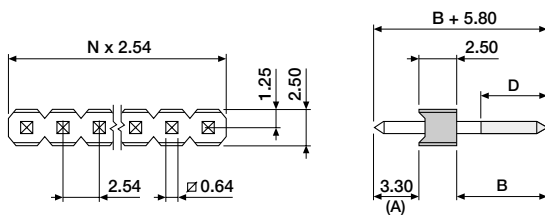

Selective gold plated section (D) 4.50mm min.
Contact sales office for other combinations of A and B dimensions and for other circuit sizes.

ORDERING INFORMATION & DIMENSIONS

62602XX-40-07 selective gold plated, 40 circuits
for pin No. see chart below

Pin No.	B	Pin No.	B	Pin No.	B	Pin No.	B
02	5.50	05	9.00	08	15.80		
03	6.80	06	12.10	09	17.00		
04	8.20	07	14.00	10	19.10		

■ Single row, straight, surface-mount

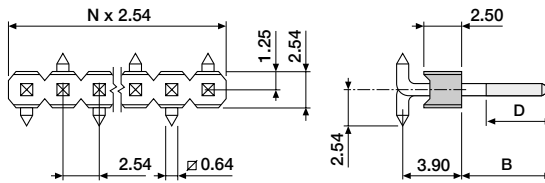

Selective gold plated section (D) 4.50mm min.
PCB Pad Size = 1.00 x 2.80mm
Contact sales office for availability of other circuit sizes.

ORDERING INFORMATION & DIMENSIONS

63602XX-40-97 selective gold plated (pin 1 down), 40 circuits
for pin No. see chart below

Pin No.	B	Pin No.	B	Pin No.	B	Pin No.	B
02	5.50	04	8.20	06	12.10		
03	6.80	05	9.00				

■ Single row, dual body, straight

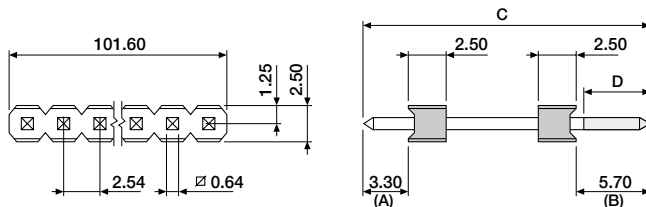

Selective gold plated section (D) 4.50mm min.
Contact sales office for other combinations of A and B dimensions and for other circuit sizes.

ORDERING INFORMATION & DIMENSIONS

64602XX-40-07-XX/XXX selective gold plated, 40 circuits
B dimension in .10mm increments
A dimension in .10mm increments
for pin No. see chart below

Pin No.	C	Pin No.	C	Pin No.	C	Pin No.	C
06	17.70	08	21.60	10	24.90		
07	19.80	09	22.80				



2.54mm Breakable Header Strips

Selective Gold Plated, 1 and 2 Rows

■ Double row, straight

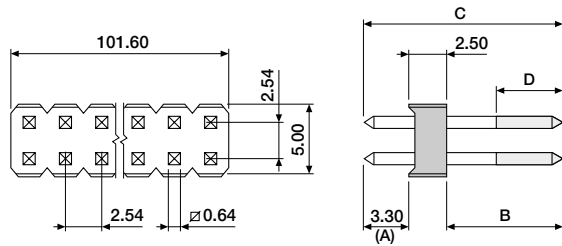

Selective gold plated section (D) 4.50mm min.
Contact sales office for other combinations of A and B dimensions and for other circuit sizes.

ORDERING INFORMATION & DIMENSIONS

62604XX-80-07 selective gold plated, 80 circuits
for pin No. see chart below

Pin No.	B	Pin No.	B	Pin No.	B	Pin No.	B
02	5.50	05	9.00	08	15.80		
03	6.80	06	12.10	09	17.00		
04	8.20	07	14.00	10	19.10		

■ Double row, straight, surface-mount

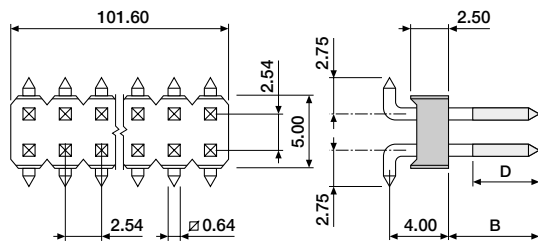

Selective gold plated section (D) 4.50mm min.
PCB Pad Size = 1.00 x 2.80mm
Contact sales office for availability of other circuit sizes.

ORDERING INFORMATION & DIMENSIONS

63604XX-80-07 selective gold plated, 80 circuits
for pin No. see chart below

Pin No.	B	Pin No.	B	Pin No.	B	Pin No.	B
02	5.50	04	8.20	06	12.10		
03	6.80	05	9.00				

■ Double row, dual body, straight

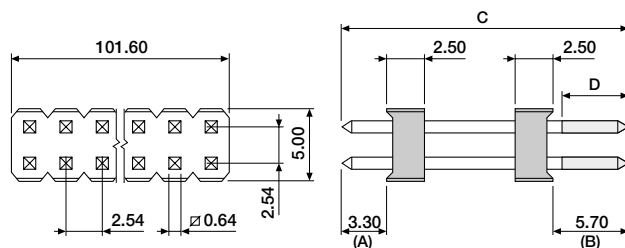

Selective gold plated section (D) 4.50mm min.
Contact sales office for other combinations of A and B dimensions and for other circuit sizes.

ORDERING INFORMATION & DIMENSIONS

64604XX-80-07-XX/XXX selective gold plated, 80 circuits
B dimension in .10mm increments
A dimension in .10mm increments
for pin No. see chart below

Pin No.	C	Pin No.	C	Pin No.	C	Pin No.	C
06	17.70	08	21.60	10	24.90		
07	19.80	09	22.80				



2.54mm Breakable Header Strips

Selective Gold Plated, 1 and 2 Rows

Single row, right-angle

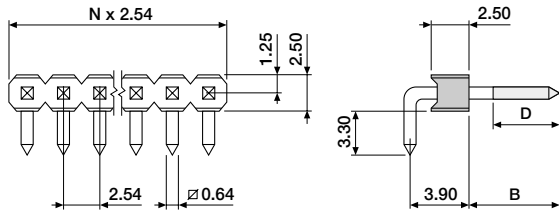

Selective gold plated section (D) 4.50mm min.
Contact sales office for other combinations of A and B dimensions and for other circuit sizes.

ORDERING INFORMATION & DIMENSIONS

62603XX-40-07 selective gold plated, 40 circuits
for pin No. see chart below

Pin No.	B	Pin No.	B	Pin No.	B	Pin No.	B
02	3.50	05	6.90	08	13.80		
03	4.80	06	9.90	09	15.00		
04	6.10	07	12.00	10	17.10		

Single row, right-angle, surface mount

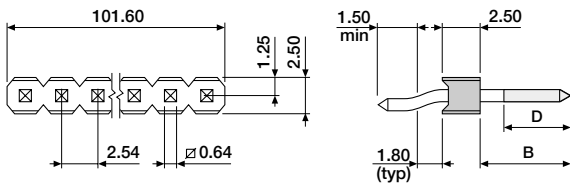

Selective gold plated section (D) 4.50mm min.
PCB Pad Size = 1.00 x 2.80mm
Contact sales office for availability of other circuit sizes.

ORDERING INFORMATION & DIMENSIONS

63603XX-40-07 selective gold plated, 40 circuits
for pin No. see chart below

Pin No.	B	Pin No.	B	Pin No.	B	Pin No.	B
02	5.50	04	8.20	06	12.10		
03	6.80	05	9.00				

Double row, right-angle

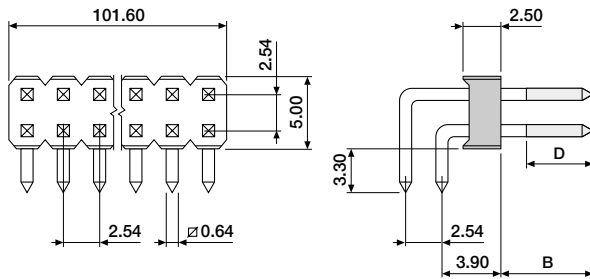

Selective gold plated section (D) 4.50mm min.
Contact sales office for availability of other circuit sizes.

ORDERING INFORMATION & DIMENSIONS

62605XX-80-07 selective gold plated, 80 circuits
for pin No. see chart below

Pin No.	B	Pin No.	B	Pin No.	B	Pin No.	B
02	3.50	04	6.10	06	9.90		
03	4.80	05	6.90	07	12.00		

Double row, right-angle, surface-mount

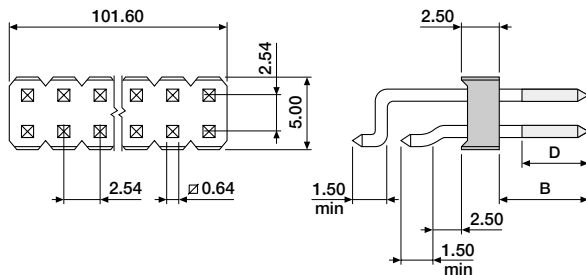

Selective gold plated section (D) 4.50mm min.
PCB Pad Size = 1.00 x 2.80mm
Contact sales office for availability of other circuit sizes.

ORDERING INFORMATION & DIMENSIONS

63605XX-80-07 selective gold plated, 80 circuits
for pin No. see chart below

Pin No.	B	Pin No.	B	Pin No.	B	Pin No.	B
02	5.50	04	8.20	06	12.10		
03	6.80	05	9.00				