

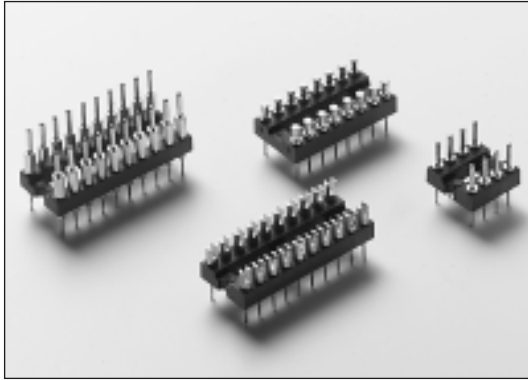

Adapter Headers, Dual In Line (DIL)

Machine Tooled Contacts



This complete range of professional DIL headers and connectors have machine tooled contacts. Most models are available with tin or gold plating.

Material : Glass-filled Polyester, UL 94V-0
Contacts : Copper Alloy
Plating : Tin or Gold over Nickel

■ Through connector, open frame

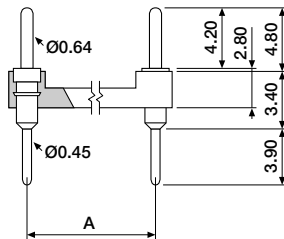

ORDERING INFORMATION

AHD-XXTC-X000 tin plated
AHD-XXTC-X020 gold plated

3 for A = 7.62, 4 for A = 10.16
6 for A = 15.24, 9 for A = 22.86

available circuit sizes:
04 to 64 (for combinations of circuit sizes
and row spacing see end of this section).

Products are subject to M.O.Q.

■ Through connector, extended, open frame

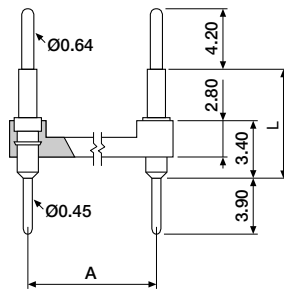

ORDERING INFORMATION

AHD-XXTE-XX00 tin plated
AHD-XXTE-XX20 gold plated

0 for L = 6.40, 1 for L = 8.40
2 for L = 15.40

3 for A = 7.62, 4 for A = 10.16
6 for A = 15.24, 9 for A = 22.86

available circuit sizes:
04 to 64 (for combinations of circuit sizes
and row spacing see end of this section).

Products are subject to M.O.Q.



Adapter Headers, Dual In Line (DIL)

Machine Tooled Contacts

■ Solder cup header, open frame

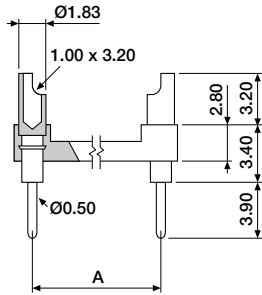

ORDERING INFORMATION

AHD-XXSC-X000 tin plated
 AHD-XXSC-X020 gold plated

3 for A = 7.62, 4 for A = 10.16
 6 for A = 15.24, 9 for A = 22.86

available circuit sizes:
 04 to 64 (for combinations of circuit sizes
 and row spacing see end of this section).

Products are subject to M.O.Q.

■ Slotted header, open frame

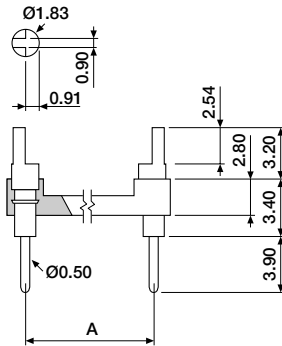

ORDERING INFORMATION

AHD-XXSL-X000 tin plated
 AHD-XXSL-X020 gold plated

3 for A = 7.62, 4 for A = 10.16
 6 for A = 15.24, 9 for A = 22.86

available circuit sizes:
 04 to 64 (for combinations of circuit sizes
 and row spacing see end of this section).

Products are subject to M.O.Q.

■ Available circuit sizes

Spacing Between Rows (A)	7.62mm										10.16mm					10.16mm					22.86mm								
Available Circuit Sizes (XX)	04	06	08	10	14	16	18	20	22	24	28	20	22	24	28	32	24	28	32	36	40	42	48	50	52	52	52	64	
AHD-XXSC-X000/X020	○	○	○	○	○	○	○	○	○	○	○	○	○	○	○	○	○	○	○	○	○	○	○	○	○	○	○	○	○
AHD-XXSL-X000/X020	○	○	○	○	○	○	○	○	○	○	○	○	○	○	○	○	○	○	○	○	○	○	○	○	○	○	○	○	○
AHD-XXTC-X000/X020	○	○	○	○	○	○	○	○	○	○	○	○	○	○	○	○	○	○	○	○	○	○	○	○	○	○	○	○	○
AHD-XXTE-XX00/XX20	○	○	○	○	○	○	○	○	○	○	○	○	○	○	○	○	○	○	○	○	○	○	○	○	○	○	○	○	○

