

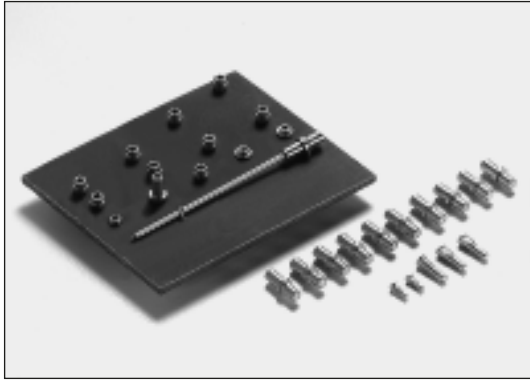

# PCB Sockets

## Machine Tooled Contacts



These sockets are intended to fit directly into PCB's prior to soldering. The contacts are of a two part construction, an outer shell fitted with an inner four (three) fingered spring contact. Some models have a self-retaining feature (S.R.F.).

Series 80 models are all light press fit into the PCB. These models are very low profile and sealed (with RTV) or unsealed.

Material : Copper Alloy (outer shell)  
Beryllium Copper (spring contact)  
Plating : Tin or Gold over Nickel

### 0.80mm Socket

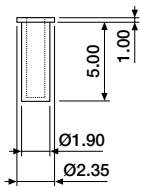

Model 11  
PCB Hole Size = Ø1.91/2.01mm

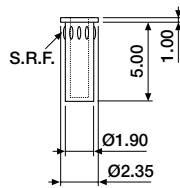

Model 13  
PCB Hole Size = Ø1.91/1.96mm

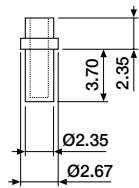

Model 21  
PCB Hole Size = Ø1.91/2.01mm

#### ORDERING INFORMATION

PCO-08DS-XX70 tin plated shell, gold plated clip  
PCO-08DS-XX20 gold plated shell and clip  
available models:  
11, 13, 21

### 1.00mm Socket

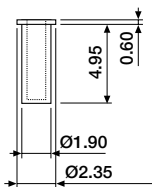

Model 11  
PCB Hole Size = Ø1.91/2.01mm

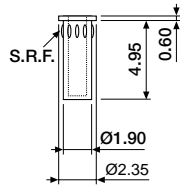

Model 13  
PCB Hole Size = Ø1.91/1.96mm

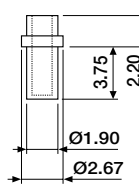

Model 21  
PCB Hole Size = Ø1.91/2.01mm

#### ORDERING INFORMATION

PCO-10DS-XX70 tin plated shell, gold plated clip  
PCO-10DS-XX20 gold plated shell and clip  
available models:  
11, 13, 21, 23, 31, 41

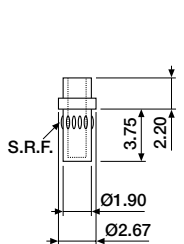

Model 23  
PCB Hole Size = Ø1.91/1.96mm

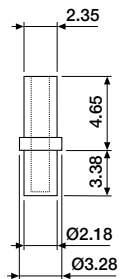

Model 31  
PCB Hole Size = Ø2.19/2.29mm

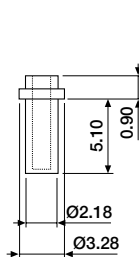

Model 41  
PCB Hole Size = Ø2.19/2.24mm



# PCB Sockets

## Machine Tooled Contacts

### 1.00mm Socket (contd.)

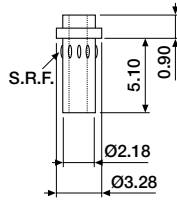
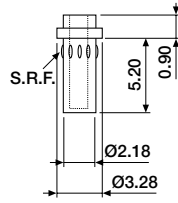
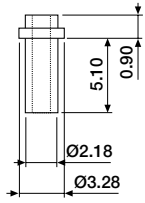

#### ORDERING INFORMATION

PCO-10DS-XX70 tin plated shell, gold plated clip  
PCO-10DS-XX20 gold plated shell and clip

available models:  
42, 43, 44, 51, 61

Model 42

PCB Hole Size = Ø2.19/2.24mm

Model 43

PCB Hole Size = Ø2.19/2.24mm

Model 44

PCB Hole Size = Ø2.19/2.24mm Models 42 and 44 are open ended.

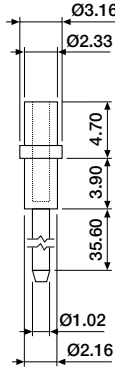
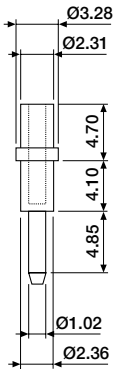

Model 51

PCB Hole Size = Ø2.37/2.47mm

Model 61

PCB Hole Size = Ø2.37/2.47mm

### 2.00mm socket

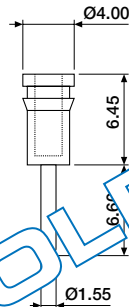
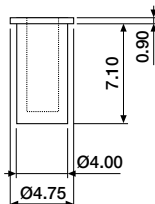
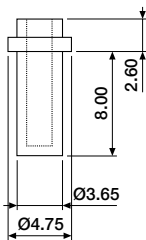

#### ORDERING INFORMATION

PCO-20DS-XX00 tin plated shell and clip  
PCO-20DS-XX20 tin plated shell, gold plated clip

available models:  
11, 21, 31

Model 11

PCB Hole Size = Ø3.67/3.77mm

Model 21

PCB Hole Size = Ø4.02/4.12mm

Model 31

PCB Hole Size = Ø3.50/3.55mm



### ■ Sockets for round and rectangular pins

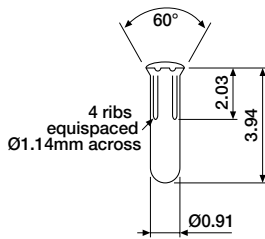

Model 80/81 for Ø0.50mm round pins  
PCB Hole Size = Ø0.95/1.05mm

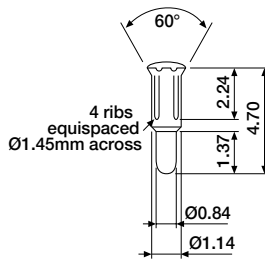

Model 82/83 for Ø0.60mm round pins  
PCB Hole Size = Ø1.22/1.32mm

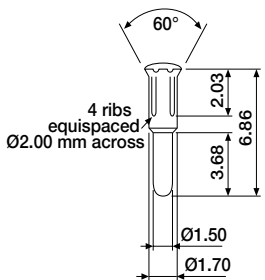

Model 84/85 for Ø0.80mm round pins  
PCB Hole Size = Ø1.80/1.90mm

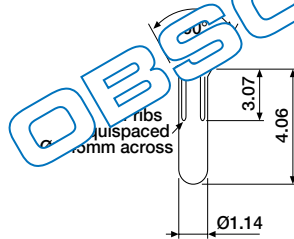

Model 86/87 for 0.27mm x 0.45mm rectangular pins  
PCB Hole Size = Ø1.25/1.35mm

#### ORDERING INFORMATION

PCO-05DS-8020	tin plated shell, gold plated clip
PCO-05DS-8120	tin plated shell, gold plated clip, sealed
PCO-06DS-8220	tin plated shell, gold plated clip
PCO-06DS-8320	tin plated shell, gold plated clip, sealed
PCO-08DS-8420	tin plated shell, gold plated clip
PCO-08DS-8520	tin plated shell, gold plated clip, sealed
PCO-10DS-8620	tin plated shell, gold plated clip
PCO-20DS-8720	tin plated shell, gold plated clip, sealed

### ■ Surface mount socket

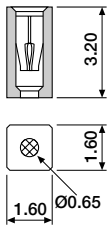

For Ø0.50mm pins

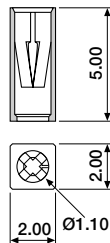

For Ø1.00mm pins

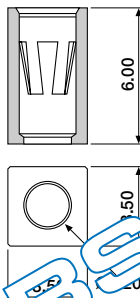

For Ø2.00mm pins

#### ORDERING INFORMATION

PCO-05SM-0000	tin plated shell and clip
PCO-05SM-0020	tin plated shell, gold plated clip
PCO-10SM-0000	tin plated shell and clip
PCO-10SM-0020	tin plated shell, gold plated clip
PCO-20SM-0000	tin plated shell and clip
PCO-20SM-0020	tin plated shell, gold plated clip