



# Shorting Plugs, Sockets and Plugs

## Machine Tooled Contacts, Insulated and Uninsulated



A selection of 1.00mm to 0.50mm PCB terminals together with 1.00mm insulated plugs, sockets and shorting plugs to be used together with 1.00mm PCB sockets. The insulated plugs and sockets are for wire mountings.

Material : Polyacetol Thermoplastic  
Contacts : Copper Alloy (pins)  
Beryllium Copper (female contacts)  
Plating : Tin or Gold over Nickel

### ■ Uninsulated shorting plug

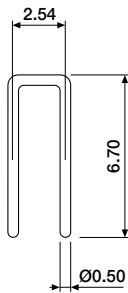

USP-1000-0520 gold plated

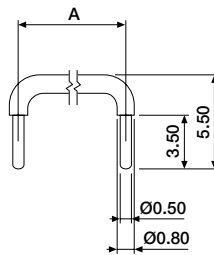

USP-1000-1500 A = 2.54 tin plated  
USP-1000-1520 A = 2.54 gold plated  
USP-2000-1500 A = 5.08 tin plated  
USP-2000-1520 A = 5.08 gold plated

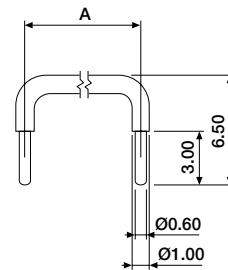

USP-1000-1600 A = 2.54 tin plated  
USP-1000-1620 A = 2.54 gold plated  
USP-2000-1600 A = 5.08 tin plated  
USP-2000-1620 A = 5.08 gold plated  
USP-3000-1600 A = 7.62 tin plated  
USP-3000-1620 A = 7.62 gold plated  
USP-4000-1600 A = 10.16 tin plated  
USP-4000-1620 A = 10.16 gold plated

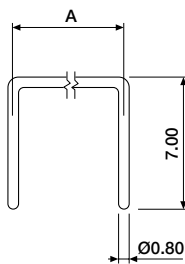

USP-1000-0820 A = 2.54 gold plated  
USP-2000-0820 A = 5.08 gold plated

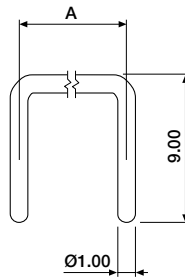

USP-2000-1100 A = 5.08 tin plated  
USP-2000-1120 A = 5.08 gold plated  
USP-4000-1100 A = 10.16 tin plated  
USP-4000-1120 A = 10.16 gold plated



# Shorting Plugs, Sockets and Plugs

## Machine Tooled Contacts, Insulated and Uninsulated

### ■ Insulated 1.00mm shorting plug

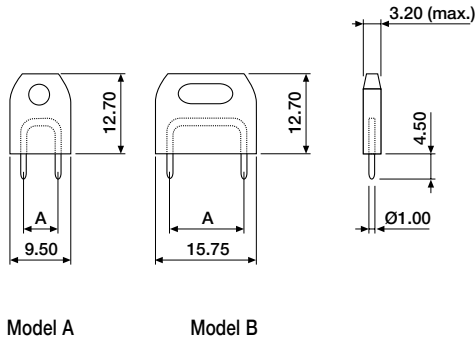

#### ORDERING INFORMATION

ISP-XX00-0000	gold plated, colour: black
ISP-XX00-0002	gold plated, colour: red
ISP-XX00-0006	gold plated, colour: blue

available centre spacings:  
20 for A = 5.08mm, model A  
25 for A = 6.35mm, model A  
40 for A = 10.16mm, model B  
50 for A = 12.70mm, model B

### ■ Insulated 1.00mm plug & socket for wire mounting

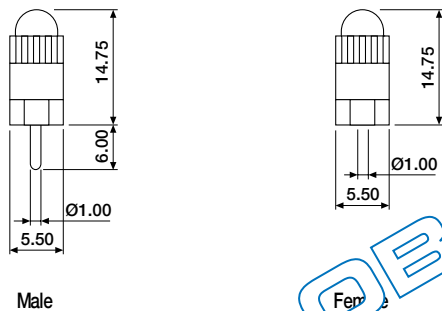

#### ORDERING INFORMATION

IPL-XXHS-0000	male, gold plated, colour: black
IPL-XXHS-0002	male, gold plated, colour: red
IPL-XXHS-0009	male, gold plated, colour: white
ISO-XXHS-0000	female, gold plated, colour: black
ISO-XXHS-0002	female, gold plated, colour: red
ISO-XXHS-0009	female, gold plated, colour: white

**OBSOLETE**