

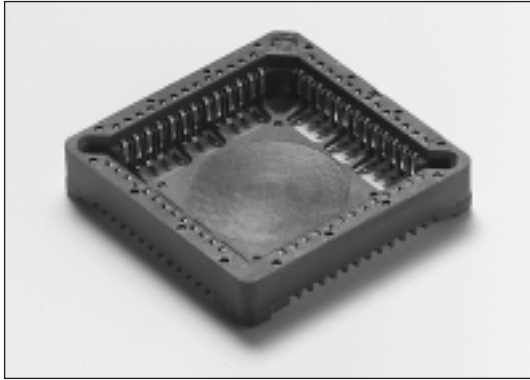

PLCC Sockets (Low Profile)

Surface-mount



A series of commercial, high quality, surface-mount PLCC sockets. Sockets will accept plastic chip carriers conforming with JEDEC specifications. The sockets use the same board pattern as the standard chips.

- Contacts : Beryllium Copper
- Plating : Tin over Nickel
- Coplanarity : $\leq 0.11\text{mm}$
- Electrical : See Chapter 15

■ PLCC Socket (surface-mount)

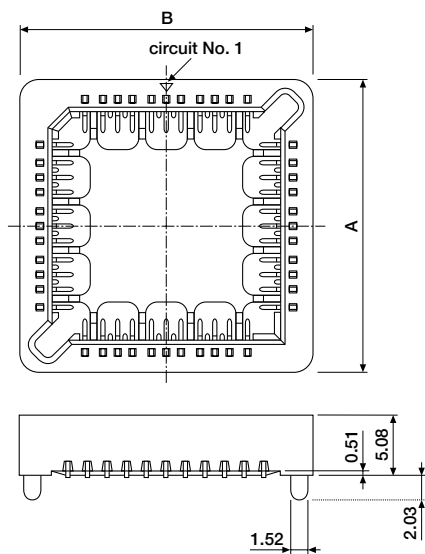

ORDERING INFORMATION

- PLS-XXSM-0000 without location pegs (standard)
 - PLS-XXSM-1000 with location pegs
- available circuit sizes:
20, 28, 32, 44, 52, 68, 84
- HGS-50EX-1000 extractor tool, 1.10mm wide tip

DIMENSIONS

Circuit Size	A	B	Circuit Size	A	B
20	15.24	15.24	52	25.40	25.40
28	17.78	17.78	68	30.48	30.48
32	20.32	17.78	84	35.56	35.56
44	22.86	22.86			

■ PCB Layout (component side)

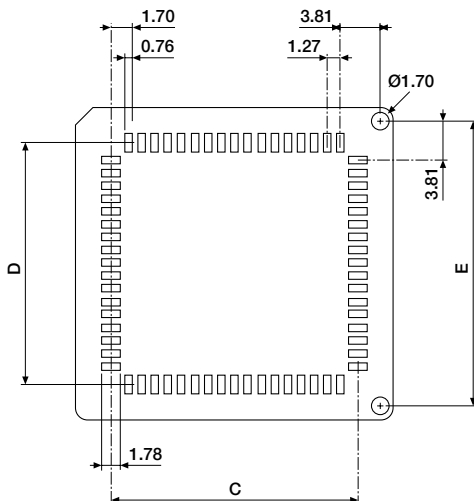

DIMENSIONS

Circuit Size	C	D	E	Circuit Size	C	D	E
20	8.48	8.48	12.70	52	18.64	18.64	22.86
28	11.02	11.02	15.24	68	23.72	23.72	27.94
32	11.02	13.56	17.78	84	28.80	28.80	33.02
44	16.10	16.10	20.32				