

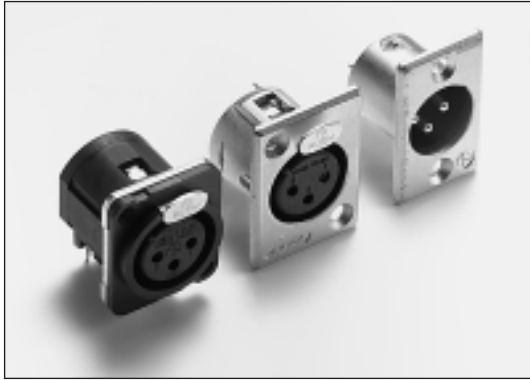

XLR Connectors

Panel and Panel/PCB-mount



- 0 Series : Smallest available 'classics'
- 2 Series : Unified metal shell for male and female. RF protected.
- 3 Series : Unified metal shell for male and female. Insert pre-mounted to PCB, shell to enclosure, front locked/unlocked. RF protected.

- Material : Die Cast Zinc (shell)
Glass-filled Polyester (insert)
- Contacts : Copper Alloy (male)
Phosphor Bronze (female)
- Plating : Silver or Gold over Nickel
- Electrical : See Chapter 15

■ Panel-mount, male

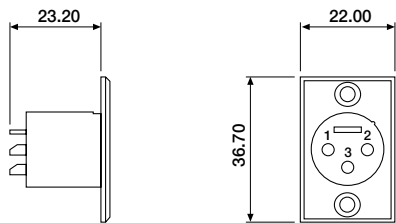

0 Series

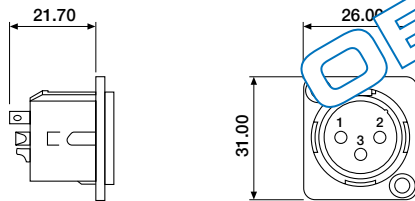

2 Series

ORDERING INFORMATION

- NCM-XXHP-0100 nickel shell, silver plated contacts
- M-XXHP-0520 black shell, gold plated contacts
- available circuit sizes: 03, 04, 05, 06

- NCM-XXHP-2100 nickel shell, silver plated contacts
- NCM-XXHP-2520 black shell, gold plated contacts
- available circuit sizes: 03, 04, 05, 06, 07

■ Panel-mount, female

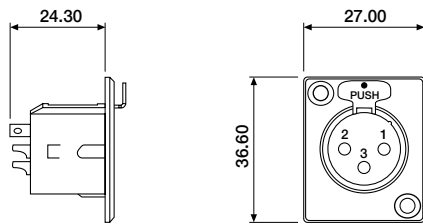

0 Series

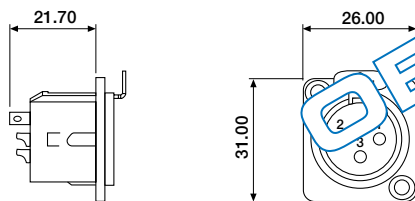

2 Series

ORDERING INFORMATION

- NCF-XXHP-0100 nickel shell, silver plated contacts
- NCF-XXHP-0520 black shell, gold plated contacts
- available circuit sizes: 03, 04, 05, 06, 07

- NCF-XXHP-2100 nickel shell, silver plated contacts
- NCF-XXHP-2520 black shell, gold plated contacts
- available circuit sizes: 03, 04, 05, 06, 07



XLR Connectors

Panel and Panel/PCB-mount Models

■ Panel/PCB-mount, male

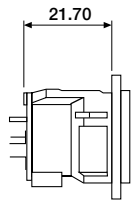

0 Series

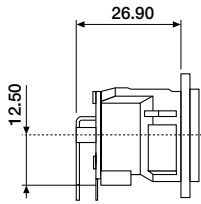

1 Series

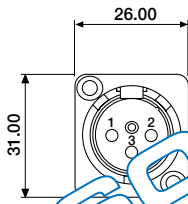

OPTIONAL INFORMATION

- NCM-03DP-0100** straight, nickel shell, silver plated contacts
- NCM-03DP-0520** straight, black shell, gold plated contacts
- NCM-03DP-1100** right-angle, nickel shell, silver plated contacts
- NCM-03DP-1520** right-angle, black shell, gold plated contacts

■ Panel/PCB-mount, female

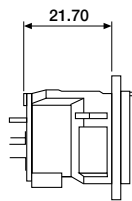

0 Series

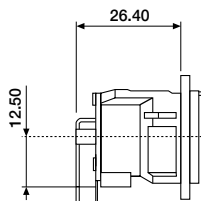

1 Series

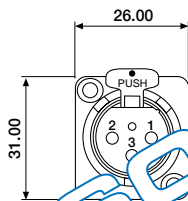

OPTIONAL INFORMATION

- NCF-03DP-0100** straight, nickel shell, silver plated contacts
- NCF-03DP-0520** straight, black shell, gold plated contacts
- NCF-03DP-1100** right-angle, nickel shell, gold plated contacts
- NCF-03DP-1520** right-angle, black shell, gold plated contacts



XLR Connectors

Panel and Panel/PCB-mount

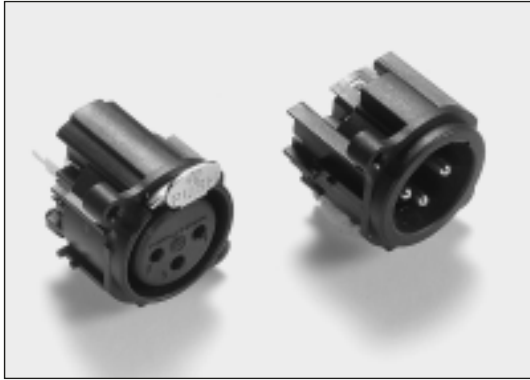

2 series : A low cost plastic panel/PCB-mount male/female series, for high density packaging. A newly designed tuning fork female contact with large, polished contact areas gives excellent quality/price performance. Direct connection of pin 1 to chassis ground is available.

3 series : As series A, but with metal shell and plastic insert.

Material : Die Cast Zinc (shell)
Glass-filled Polyester UL 94V-0

Contacts : Copper Alloy (male)
Phosphor Bronze (female)

Plating : Hard Gold (0.1 μ) over 2 μ Nickel

Electrical : See Chapter 15

■ Panel/PCB-mount, male

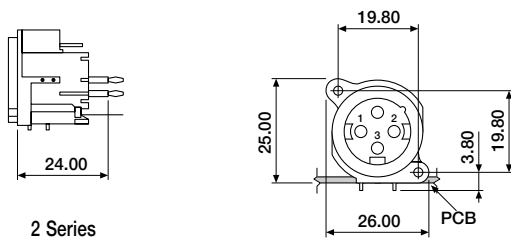

2 Series

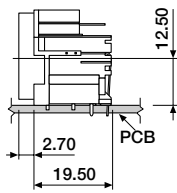

3 Series

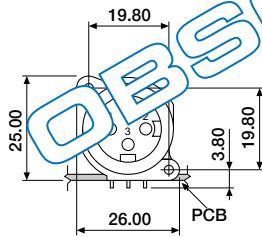

ORDERING INFORMATION

NCM-03DP-2X20 male, straight
NCM-03DP-3X20 male, right-angle

0 = plastic
1 = metal flange

Contact sales office for models with black metal flanges.

■ Panel/PCB-mount, female

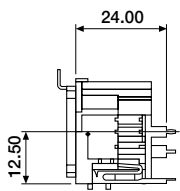

2 Series

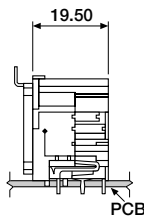

3 Series

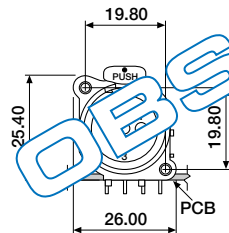
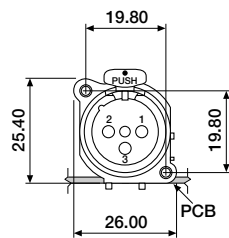

ORDERING INFORMATION

NCF-03DP-2X21 straight with latch lock
NCF-03DP-2X22 straight with latch lock
NCF-03DP-2X23 straight with retention spring
NCF-03DP-2X24 straight with retention spring
NCF-03DP-3X21 right-angle with latch lock
NCF-03DP-3X22 right-angle with latch lock
NCF-03DP-3X23 right-angle with retention spring
NCF-03DP-3X24 right-angle with retention spring

0 = plastic
1 = metal flange

Contact sales office for models with black metal flanges.
Models ending with 1 or 3 = pin 1 connected to chassis/shell ground.
Models ending with 2 or 4 = pin 1 separated from chassis/ shell ground.



XLR Connectors

Panel and Panel/PCB-mount

■ PCB layouts

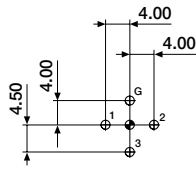

Male straight
0 series

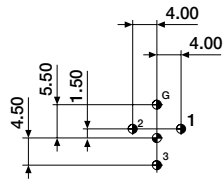

Female straight
0 series

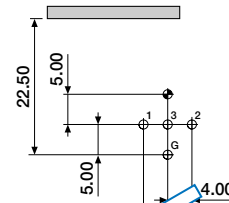

Male right-angle
1 series

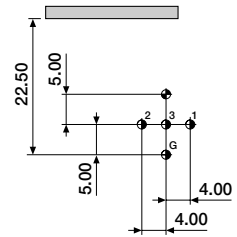

Female right-angle
1 series

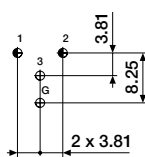

Male straight
2 series

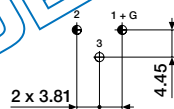

Female straight
2 series

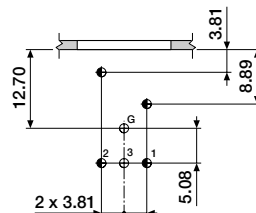

Male right-angle
3 series

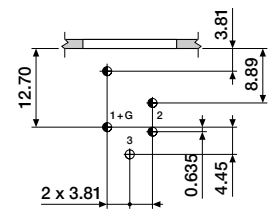

Female right-angle
3 series

Hole sizes: $\oplus \text{Ø}1.20$ $\ominus \text{Ø}1.80$ $\oplus \text{Ø}2.10$ $\oplus \text{Ø}2.60$ $\ominus \text{Ø}1.60$ $\oplus \text{Ø}2.00$ $\bullet \text{Ø}2.30$

■ Panel cut outs

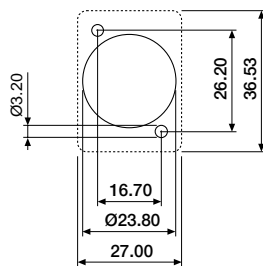

Female
0 series (HP)

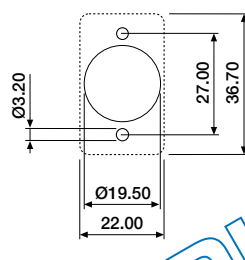

Male/Female
2 and 3 series (DP)
2 series (HP)

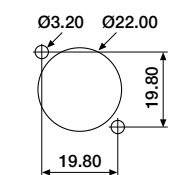
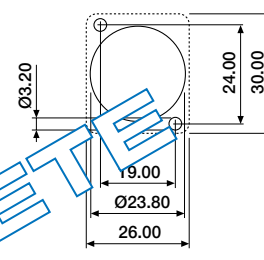

Male/Female
2 and 3 series (DP)