



# PCB Terminals and Turret Lugs

## Machine Tooled



A range of special machine tooled terminals and turret lugs for PCB applications. Turret lugs have to be riveted to remain in the PCB. Swagging tools can be ordered by changing the first three letters of the order number into HGS. Some terminals are subject to M.O.Q.

Material : Brass  
Plating : Tin or Gold over Nickel  
Tolerances : If tolerances are important, ask for individual sales drawings

### ■ PCB terminals, HPT series

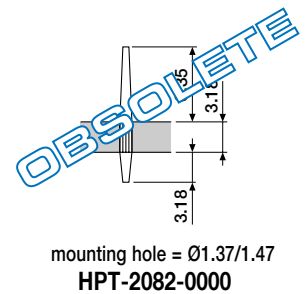
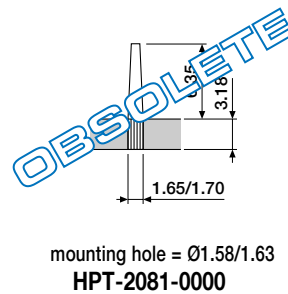
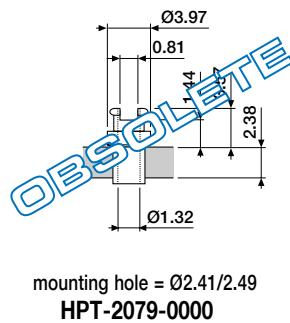
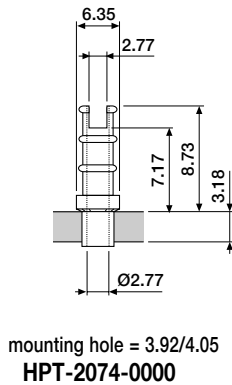
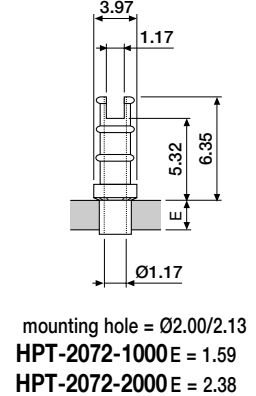
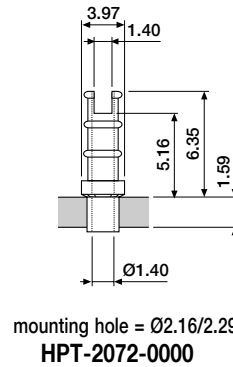
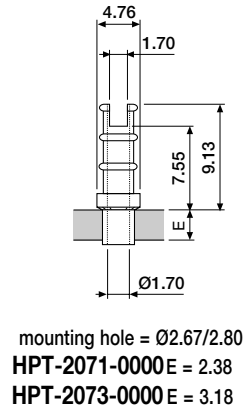
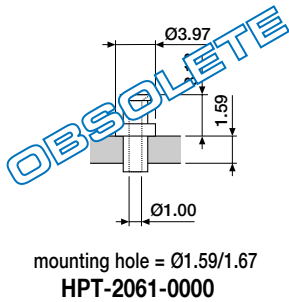
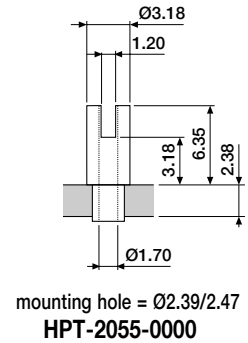
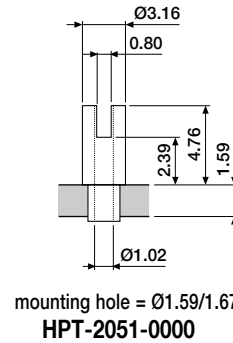
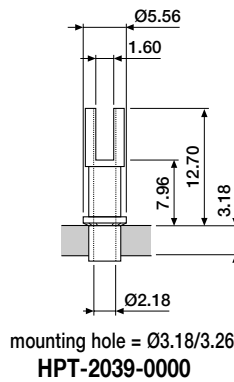
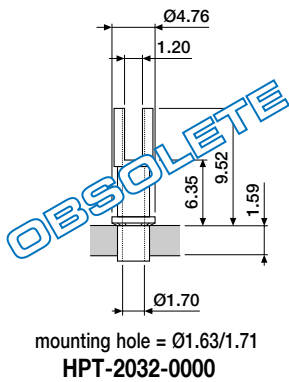



# PCB Terminals and Turret Lugs

## Machine Tooled

### ■ PCB terminals, HPT series (contd.)

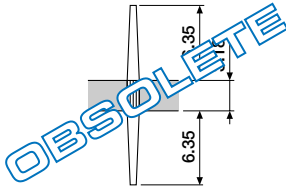

mounting hole =  $\varnothing 1.67/1.70$   
HPT-2083-0000

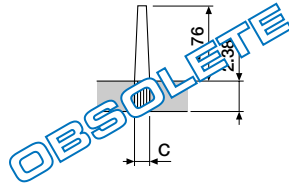

HPT-2085-0000 C =  $\varnothing 1.40/1.45$   
HPT-2088-0000 C =  $\varnothing 1.10/1.15$

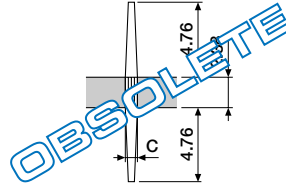

HPT-2087-0000 C =  $\varnothing 1.40/1.45$   
HPT-2089-0000 C =  $\varnothing 1.10/1.15$

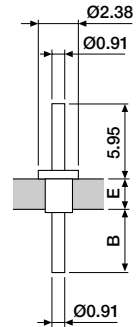

mounting hole =  $\varnothing 1.78/1.86$   
HPT-2101-0000 B = 6.75, E = 1.59

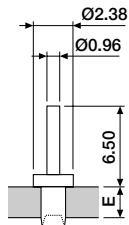

mounting hole =  $\varnothing 1.78/1.86$   
HPT-2101-1000 E = 1.59

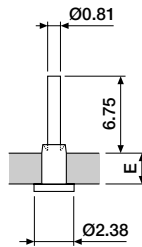

mounting hole =  $\varnothing 1.78/1.86$   
HPT-2101-2000 E = 1.59  
HPT-2102-2000 E = 2.38  
HPT-2103-2000 E = 3.18

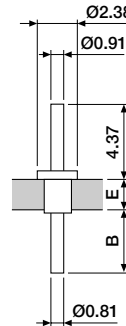

mounting hole =  $\varnothing 1.32/1.40$   
HPT-2105-0000 B = 3.37, E = 1.59

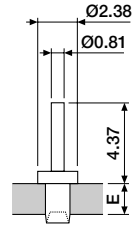

mounting hole =  $\varnothing 1.32/1.40$   
HPT-2105-1000 E = 1.59  
HPT-2106-1000 E = 2.38

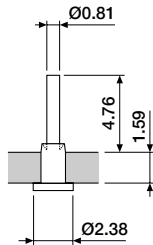

mounting hole =  $\varnothing 1.32/1.40$   
HPT-2105-2000

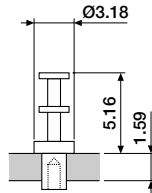

mounting hole =  $\varnothing 1.68/1.73$   
HPT-2121-0000

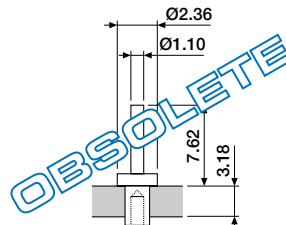

mounting hole =  $\varnothing 1.15/1.20$   
HPT-2152-0000

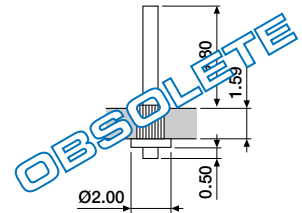

mounting hole =  $\varnothing 1.30/1.40$   
HPT-2157-0000

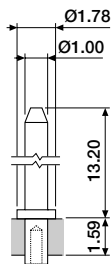

mounting hole =  $\varnothing 1.04/1.14$   
HPT-2170-0000 tin plated

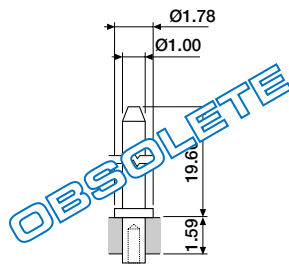

mounting hole =  $\varnothing 1.04/1.14$   
HPT-2171-0000 tin plated

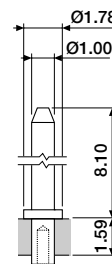

mounting hole =  $\varnothing 1.04/1.14$   
HPT-2173-0000 tin plated  
HPT-2173-0020 gold plated

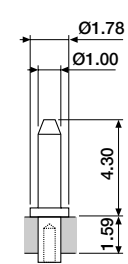

mounting hole =  $\varnothing 1.04/1.14$   
HPT-2174-0000 tin plated



# PCB Terminals and Turret Lugs

## Machine Tooled

### ■ PCB terminals, HPT series (contd.)

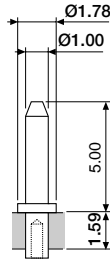

mounting hole = Ø1.04/1.14  
HPT-2175-0000 tin plated

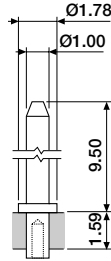

mounting hole = Ø1.04/1.14  
HPT-2176-0000 tin plated

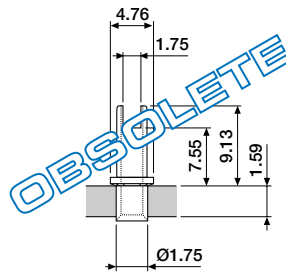

mounting hole = Ø2.67/2.75  
HPT-3073-0000

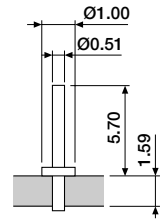

mounting hole = Ø0.50/0.55  
HPT-3108-0000

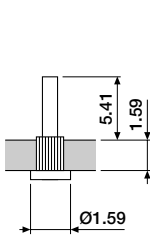

mounting hole = Ø0.95/1.00  
HPT-3150-0000

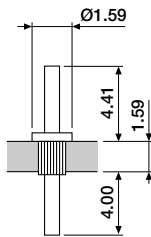

mounting hole = Ø0.95/1.00  
HPT-3151-0000

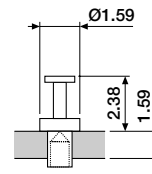

mounting hole = Ø1.24/1.32  
HPT-9001-0000

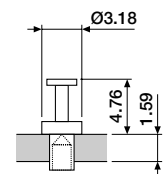

mounting hole = Ø2.01/2.09  
HPT-9004-0000

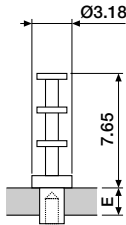

mounting hole = Ø2.34/2.49  
HPT-9020-0000 E = 1.59  
HPT-9021-0000 E = 2.38

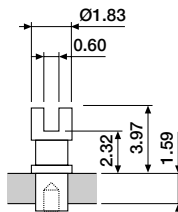

mounting hole = Ø1.27/1.43  
HPT-9023-0000

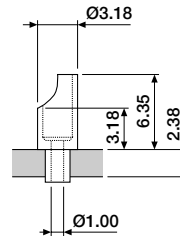

mounting hole = Ø1.83/1.93  
HPT-9026-0000

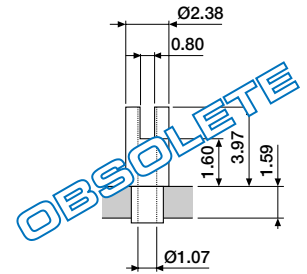

mounting hole = Ø2.39/2.47  
HPT-9036-0000

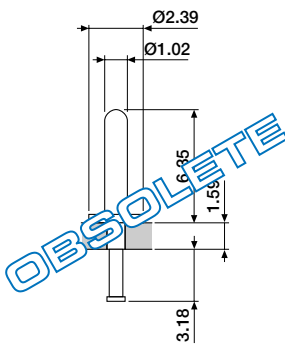

mounting hole = Ø1.83/1.88  
HPT-9051-0000

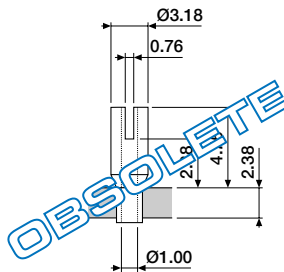

mounting hole = Ø1.52/1.55  
HPT-9067-0000

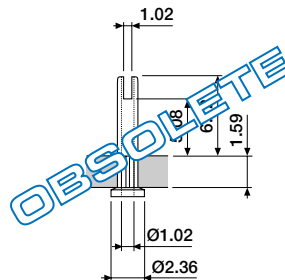

mounting hole = Ø1.80/1.85  
HPT-9087-0000