

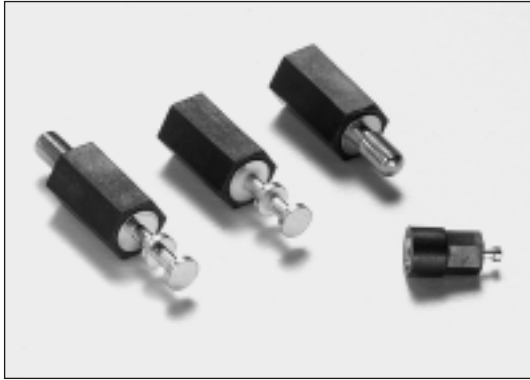

# Insulators



A series of high temperature thermoplastic insulators with tin plated brass terminals and nickel plated threaded inserts.

## ■ Series 1000

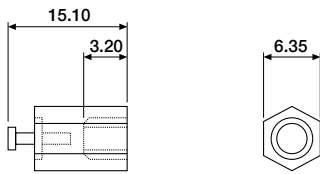

### ORDERING INFORMATION

INS-1000-3000

M3 thread, 10A at 5kv, Test voltage 10kv

## ■ Series 1100

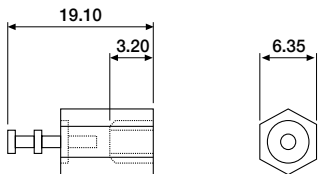

### ORDERING INFORMATION

INS-1100-3000

M3 thread, 10A at 5kv, Test voltage 10kv

## ■ Series 1300

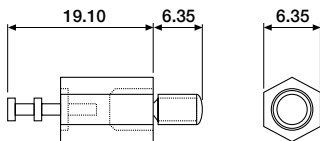

### ORDERING INFORMATION

INS-1300-3000

M3 thread, 10A at 5kv, Test voltage 10kv

## ■ Series 1400, teflon

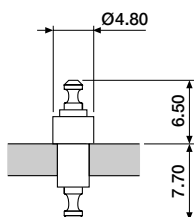

Assembled dimensions

### ORDERING INFORMATION

INS-1400-3000

5A at 5kv, 200C

Panel Thickness = 0.70/1.60mm